

Soils Map

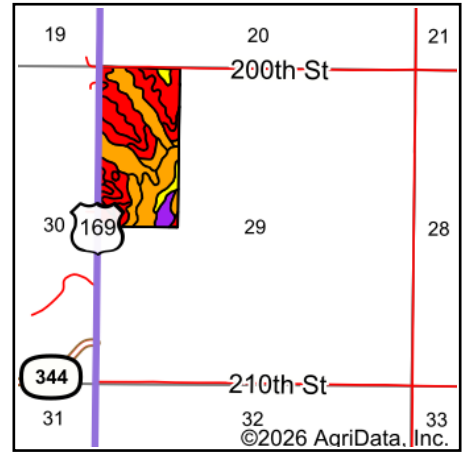

State: **Iowa**
 County: **Ringgold**
 Location: **29-69N-29W**
 Township: **Liberty**
 Acres: **80**
 Date: **4/27/2026**

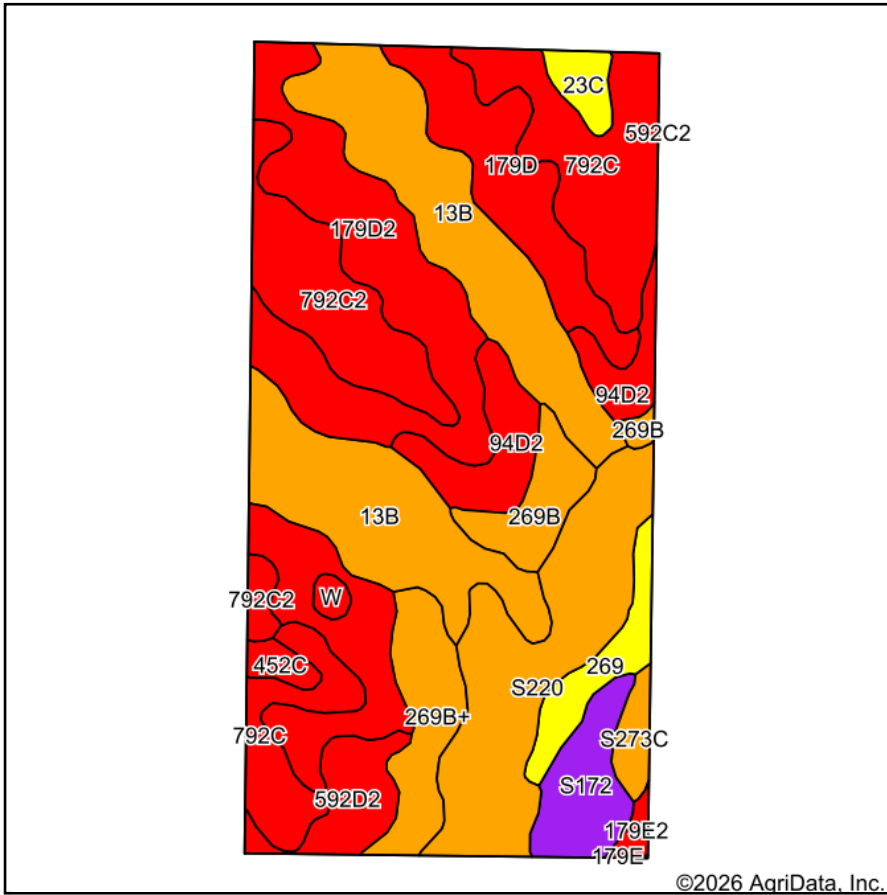

Maps Provided By:

 CUSTOMIZED ONLINE MAPPING
 © AgriData, Inc. 2025 www.AgriDataInc.com



Soils data provided by USDA and NRCS.

Area Symbol: IA159, Soil Area Version: 31

Code	Soil Description	Acres	Percent of field	CSR2 Legend	Soil Drainage	Non-Irr Class *c	*i Water-Holding Inch	CSR2**	CSR	*n NCCPI Overall
13B	Olmitz-Zook-Humeston complex, 0 to 5 percent slopes	16.29	20.3%		Poorly drained	IIw	11.7	78	59	79
179D2	Gara loam, 9 to 14 percent slopes, moderately eroded	14.28	17.8%		Well drained	IVe	10.7	38	43	66
792C	Armstrong loam, 5 to 9 percent slopes	9.30	11.6%		Somewhat poorly drained	IIIe	9.2	35	31	67
S220	Nodaway silt loam, heavy till, 0 to 2 percent slopes, occasionally flooded	9.17	11.5%		Moderately well drained	IIw	0.0	77		87
792C2	Armstrong clay loam, 5 to 9 percent slopes, moderately eroded	5.66	7.1%		Somewhat poorly drained	IIIe	9.2	24	27	60
179D	Gara loam, 9 to 14 percent slopes	5.11	6.4%		Well drained	IVe	10.7	42	45	71
94D2	Mystic-Caleb complex, 9 to 14 percent slopes, moderately eroded	3.97	5.0%		Somewhat poorly drained	IVe	9.7	20	13	71
269B+	Humeston silt loam, 2 to 5 percent slopes, overwash, rarely flooded	3.44	4.3%		Poorly drained	IIIw	10.1	71	58	80
S172	Wabash silty clay, 0 to 2 percent slopes, occasionally flooded	2.83	3.5%		Very poorly drained	IIIw		57		59
269B	Humeston silty clay loam, 2 to 5 percent slopes, rarely flooded	2.48	3.1%		Poorly drained	IIIw	10.1	71	53	88
592D2	Mystic clay loam, 9 to 14 percent slopes, moderately eroded	2.31	2.9%		Somewhat poorly drained	IVe	10.5	10	5	67

Soils data provided by USDA and NRCS.



Code	Soil Description	Acres	Percent of field	CSR2 Legend	Soil Drainage	Non-Irr Class *c	*i Water-Holding Inch	CSR2**	CSR	*n NCCPI Overall
269	Humeston silty clay loam, 0 to 2 percent slopes, occasionally flooded	2.05	2.6%		Poorly drained	IIIw	10.1	70	58	90
23C	Arispe silty clay loam, 5 to 9 percent slopes	0.97	1.2%		Somewhat poorly drained	IIIe	11.7	66	55	78
S273C	Olmitz loam, heavy till, 5 to 9 percent slopes	0.87	1.1%		Moderately well drained	IIIe	0.0	77		85
452C	Lineville silt loam, 5 to 9 percent slopes	0.60	0.8%		Somewhat poorly drained	IIIe	10.8	48	36	75
179E2	Gara loam, 14 to 18 percent slopes, moderately eroded	0.34	0.4%		Well drained	VIe	10.7	24	33	62
W	Water	0.33	0.4%				0.0	0	0	
Weighted Average						*-	8.8	52.4	*-	*n 73.1

**IA has updated the CSR values for each county to CSR2.

*- CSR weighted average cannot be calculated on the current soils data, use prior data version for csr values.*i Yield data provided by the ISPAID Database version 8.1.1 developed by IA State University.

*n: The aggregation method is "Weighted Average using all components"

*c: Using Capabilities Class Dominant Condition Aggregation Method

*- Non Irr Class weighted average cannot be calculated on the current soils data due to missing data.