

Soils Map

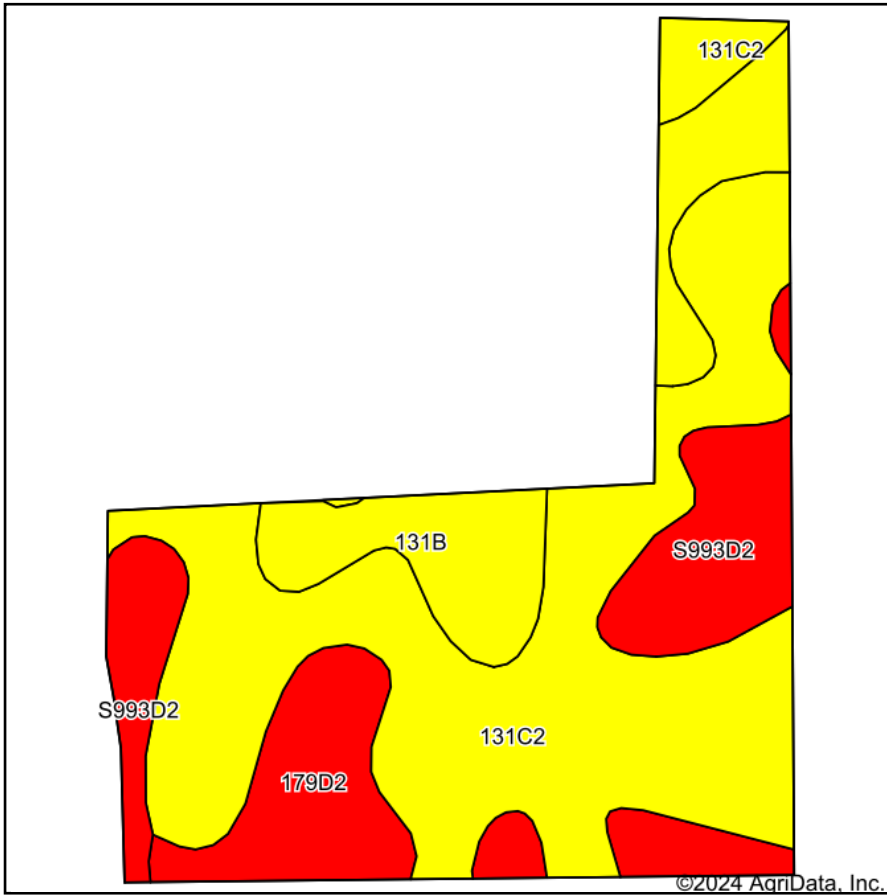

Soils data provided by USDA and NRCS.

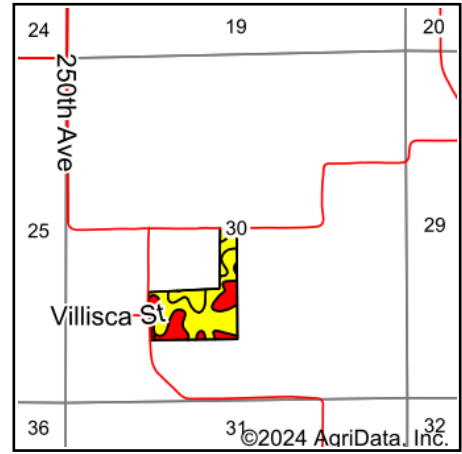

State: **Iowa**
 County: **Marion**
 Location: **30-74N-21W**
 Township: **Dallas**
 Acres: **29**
 Date: **3/7/2024**



Maps Provided By:

 CUSTOMIZED ONLINE MAPPING
 © AgriData, Inc. 2023 www.AgriDataInc.com



Area Symbol: IA125, Soil Area Version: 33

Code	Soil Description	Acres	Percent of field	CSR2 Legend	Non-Irr Class *c	CSR2**	CSR	*n NCCPI Overall	*n NCCPI Corn	*n NCCPI Small Grains	*n NCCPI Soybeans	
131C2	Pershing silt loam, 5 to 9 percent slopes, moderately eroded	16.10	55.5%		IIIe	62	49	68	68	63	51	
131B	Pershing silt loam, 2 to 5 percent slopes	4.48	15.4%		IIIe	70	72	74	74	70	59	
S993D2	Gara-Armstrong complex, 9 to 14 percent slopes, moderately eroded	4.26	14.7%		IVe	32		65	65	53	45	
179D2	Gara loam, 9 to 14 percent slopes, moderately eroded	4.16	14.3%		IVe	38	43	66	66	54	48	
Weighted Average						3.29	55.4	*	*n 68.2	*n 68.2	*n 61.3	*n 50.9

**IA has updated the CSR values for each county to CSR2.

*- CSR weighted average cannot be calculated on the current soils data, use prior data version for csr values.

*n: The aggregation method is "Weighted Average using all components"

*c: Using Capabilities Class Dominant Condition Aggregation Method