

Soils Map

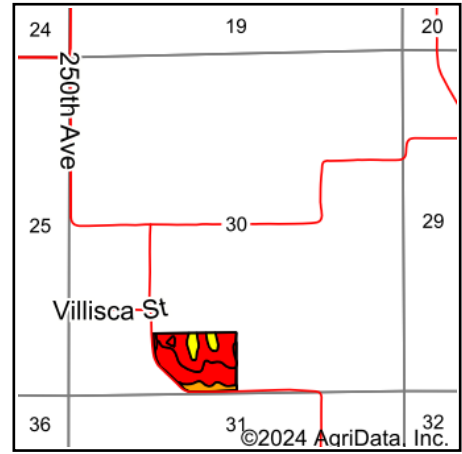

State: **Iowa**
 County: **Marion**
 Location: **30-74N-21W**
 Township: **Dallas**
 Acres: **24**
 Date: **3/7/2024**

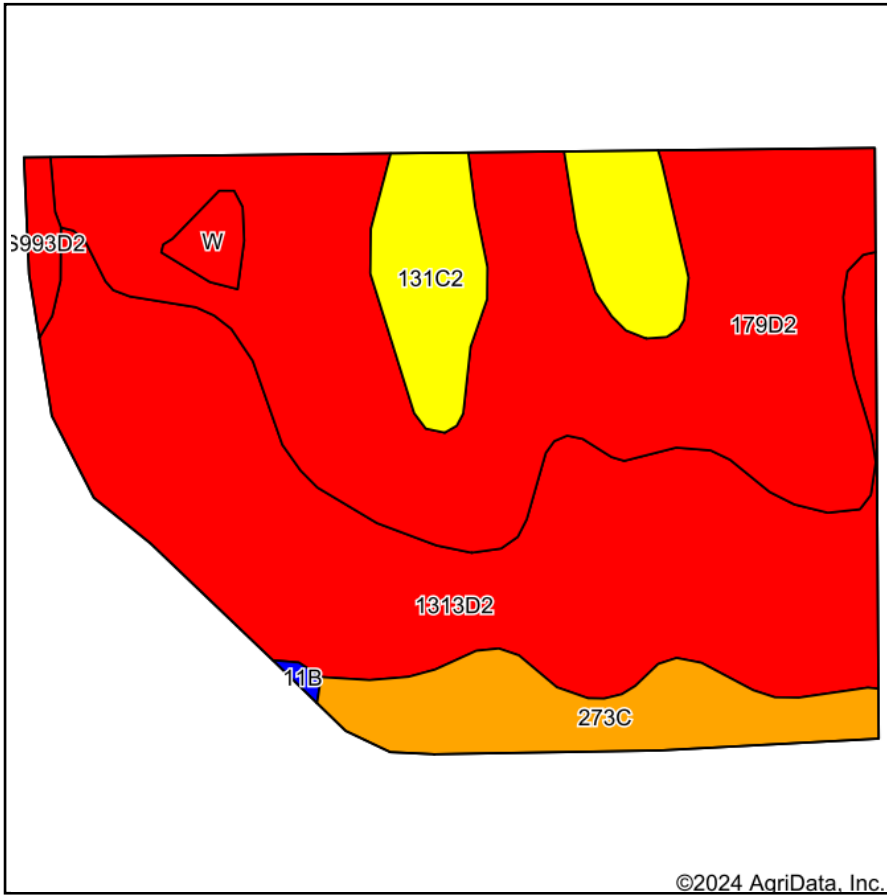

Maps Provided By:

 CUSTOMIZED ONLINE MAPPING
 © AgriData, Inc. 2023 www.AgriDataInc.com



Soils data provided by USDA and NRCS.

Area Symbol: IA125, Soil Area Version: 33

Code	Soil Description	Acres	Percent of field	CSR2 Legend	Non-Irr Class *c	CSR2**	CSR	*n NCCPI Overall	*n NCCPI Corn	*n NCCPI Small Grains	*n NCCPI Soybeans	
179D2	Gara loam, 9 to 14 percent slopes, moderately eroded	10.00	41.7%		Ive	38	43	66	66	54	48	
1313D2	Munterville silt loam, 9 to 14 percent slopes, moderately eroded	9.22	38.4%		Vle	34	10	59	59	47	42	
131C2	Pershing silt loam, 5 to 9 percent slopes, moderately eroded	2.20	9.2%		IIle	62	49	68	68	63	51	
273C	Olmitz loam, heavy till, 5 to 9 percent slopes	2.06	8.6%		IIle	77	57	85	85	71	71	
W	Water	0.27	1.1%			0	0					
S993D2	Gara-Armstrong complex, 9 to 14 percent slopes, moderately eroded	0.25	1.0%		Ive	32		65	65	53	45	
Weighted Average						*-	41.5	*-	*n 64.4	*n 64.4	*n 53	*n 47.4

**IA has updated the CSR values for each county to CSR2.

*- CSR weighted average cannot be calculated on the current soils data, use prior data version for csr values.

*n: The aggregation method is "Weighted Average using all components"

*c: Using Capabilities Class Dominant Condition Aggregation Method

*- Non Irr Class weighted average cannot be calculated on the current soils data due to missing data.

Soils data provided by USDA and NRCS.